

Lesson 6A

GRAMMAR | prepositions of place
 VOCABULARY | rooms and furniture
 PRONUNCIATION | sentence stress

VOCABULARY

rooms and furniture

1 A Complete the table with the words in the box.

armchair bath bathroom bed bedroom chair
 cooker door floor kitchen living room plant
 sofa table television toilet wall window

rooms / parts of a house	furniture / objects

B Select a word or phrase to fill the gaps.

- I usually sit on the and watch television.
 a fridge b shelf c sofa
- Is the milk in the?
 a fridge b toilet c cooker
- The has a toilet and shower.
 a kitchen b living room c bathroom
- Is my book on the?
 a shelf b window c lamp
- The garden has lots of beautiful
 a floors b plants c cookers
- My bedroom is very light – it has two big
 a walls b beds c windows
- Do you have a or a bath in your bathroom?
 a shower b cooker c sofa
- It's dark – could you turn on the please?
 a television b lamp c shelf

C Complete the text with the words in the box. There are two extra words.

armchair bed fridge garden
 kitchen lamp toilet wall

Great one-bedroom apartment in the city centre



Small, beautiful apartment in the city centre. It has a lovely living room with a big sofa, an ¹ and a television. The ² has a cooker and a ³ The bedroom has a big ⁴, a chair and a table with a beautiful ⁵ on it. It doesn't have a ⁶, but it is near a great park.

D 6.01 | Listen and check your answers.

GRAMMAR

prepositions of place

2 A Write the prepositions of place.

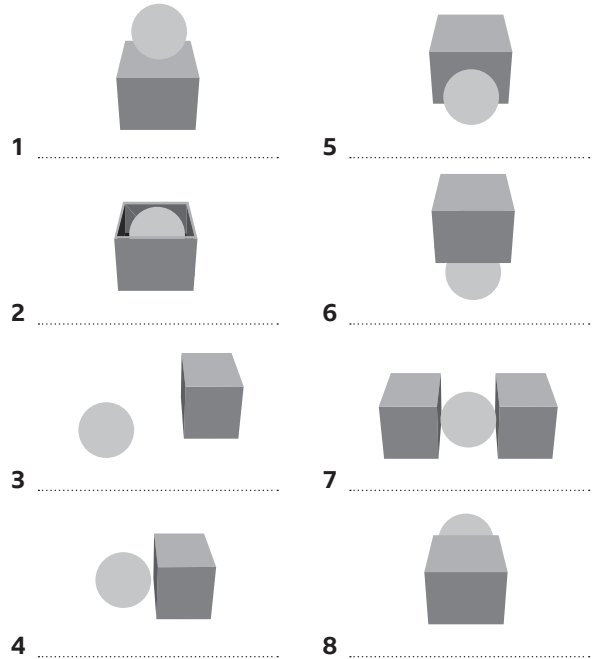

B Choose the correct alternative.

- Chang lives **on** / **under** / **in** Canada.
- Are my keys **in** / **on** / **between** the shelf?
- My sister lives **near** / **under** / **in** my house.
- Our apartment is **in** / **on** / **behind** the 4th floor.
- The cat is **behind** / **between** / **in** the sofa.
- Carlos sits **next to** / **under** / **between** me in class.
- Mika is **in** / **between** / **on** Ana and Paola.
- In the photo, Saima is **in front of** / **in** / **between** Terry.

C 6.02 | Complete the conversation with the prepositions in the box. Then listen and check.

in (x3) in front near next on (x2) under

- A: Where do you live?
 B: I live ¹ Geneva, ² to the lake.
 A: Do you live ³ an apartment or a house?
 B: An apartment. It's ⁴ the 12th floor.
 A: Is it ⁵ your office?
 B: Yes, it's only ten minutes by bike. I live with two of my colleagues. Look, you can see them ⁶ this photo. That's Eun and that's Ed.
 A: Is that your cat ⁷ the floor ⁸ of Ed?
 B: Yes, that's Mochi. He usually sleeps ⁹ my bed and we can't see him!

PRONUNCIATION

3 A  **6.03** | sentence stress | Listen and underline the main stressed words.

- 1 It's under the window.
- 2 It's on the shelf.
- 3 It's next to the bath.
- 4 It's in front of you.
- 5 Is it between the chairs?
- 6 Is it near your house?
- 7 Is it behind the bed?
- 8 Is it in the fridge?

B  **6.03** | Listen again and check your answers.

READING

4 A Match the words (1–4) with the photos (A–D).

- | | |
|--------------|-------------|
| 1 riverboat | 3 castle |
| 2 lighthouse | 4 treehouse |



B Read the article. Which places from Ex 4A are mentioned?

⋮
← → ↻



Interesting homes

My house is interesting – it's an old lighthouse in Scotland, next to the sea. The kitchen is on the ground floor. It has a cooker, a fridge and a big table. The living room is on the first floor. It has a sofa, an armchair and a television. The bathroom is next to the living room. It's small, but it has a big bath under the window. My bedroom is on the top floor. It's my favourite room because you can see the sea from every window. I have a big garden with lots of plants.

Chris

I don't live in a house – I live on a boat in India. It's a river boat – it's small but it has everything! I have three rooms – a living room, a bedroom and a bathroom. The living room has a sofa, a small table, a fridge and a cooker. It doesn't have a television. My bedroom is next to the living room. It has my bed with a lamp and a radio on a shelf. The bathroom is very small. It has a toilet and a shower, but it doesn't have a bath. I don't have a garden, but I have plants in the living room.

Anushri

C Read the article again. Are the statements True (T) or False (F)?

- 1 Chris lives in Scotland.
- 2 He lives near a river.
- 3 His favourite room is his bathroom.
- 4 Anushri lives in Thailand.
- 5 She has three rooms.
- 6 She doesn't have a bathroom.

D Read the article again. Write L (lighthouse) or R (riverboat).

- 1 It has a big table in the kitchen.
- 2 It has a fridge in the living room.
- 3 It has a sofa and an armchair in the living room.
- 4 It doesn't have a television.
- 5 It has a big bath in the bathroom.
- 6 It has a lamp in the bedroom.
- 7 It doesn't have a garden.
- 8 It has plants in the living room.

E Cover the article. Complete the sentences with the correct preposition, then check your answers in the article.

- 1 Chris lives the sea.
- 2 His living room is the 1st floor.
- 3 The bath is the window.
- 4 Anushri lives India.
- 5 Her bedroom is the living room.
- 6 She has a radio a shelf in her bedroom.

Lesson 6B

GRAMMAR | *there is, there are*
 VOCABULARY | places in town (1)
 PRONUNCIATION | linking with *there*

VOCABULARY

places in town (1)

1 A Write the place in each photo.



1 4



2 5



3 6

B Choose the correct word to complete the sentences.

- We don't have any bread. Could you get some at the please?
 a cinema b supermarket c museum
- I want to send a letter. Where's the?
 a sports centre b train station c post office
- Can you take my books to the, please?
 a library b cinema c hospital
- Excuse me, where's the bus?
 a centre b station c pool
- I often watch films at the on Saturday evenings.
 a post office b airport c cinema
- My parents usually stay in an expensive on holiday.
 a hotel b museum c library
- Farah plays tennis at the on Thursdays.
 a post office b sports centre c library
- Ray is a doctor at a big in my town.
 a hospital b museum c supermarket

GRAMMAR

there is, there are

2 A Choose the correct alternative.

- There **is** / **are** two train stations in this city.
- There **isn't** / **aren't** a swimming pool at the hotel.
- Are there **some** / **any** museums in your town?
- There **is** / **are** a cinema near my house.
- A: Is there a hospital near your house?
 B: No, there **isn't** / **aren't**.
- Is** / **Are** there a post office?
- There **isn't** / **aren't** any hotels here.
- Are there **a** / **any** good schools here?

B Complete the conversation with the correct form of *there is / are (not)*. Use contractions where possible.

- A: Do you like your new apartment?
 B: Yes, it's great! ¹..... a big kitchen, a living room and there ²..... two bedrooms.
 A: Is ³..... a garden?
 B: No, there ⁴....., but it's next to a park.
 A: Do you live in the town centre?
 B: Yes, it's great! ⁵..... a cinema, a museum and a library near me. There ⁶..... any sports centres, but ⁷..... a swimming pool.
 A: ⁸..... there a train station?
 B: No, there ⁹....., but ¹⁰..... a bus station.

C 6.04 | Listen and check your answers.

D The sentences below have a mistake. Choose the best option to correct the mistake.

- Is an airport five kilometres from my house.
 a There b There's c Are
- Are there a post office?
 a There are b There is c Is there
- A: Is there a swimming pool near the school?
 B: Yes, there are.
 a there's b is there c there is
- There aren't a libraries in the town centre.
 a any b some c no

PRONUNCIATION

3 A 6.05 | linking with *there* | Listen to the sentences and add links between the words when you hear them.

- There's a very good café.
- Are there any supermarkets near here?
- There isn't a park in the area.
- There are two museums.
- Is there a Thai restaurant?
- No, there isn't.

B 6.05 | Listen again and repeat the sentences.

LISTENING

4A **6.06** | Listen to three people talking about their towns. What do the speakers have in their towns? Match the speakers (1–3) with the photos (A–C).

- 1 Genevieve 2 Tomas 3 Liane



B **6.06** | Listen again. Choose the correct alternative.

Genevieve

- There is a **shopping centre / supermarket**.
- There isn't a **swimming pool / sports centre**.

Tomas

- There are two **hotels / restaurants**.
- There is a **library / cinema**.

Liane

- There are two **sports centres / hospitals**.
- There isn't a **train station / an airport**.

C **6.06** | Listen again. Are the statements True (T) or False (F)?

- There aren't any schools in Genevieve's town.
- Genevieve's favourite place is the park.
- Shops are important for Tomas.
- The Italian restaurant in Tomas's town is expensive.
- Liane's favourite restaurant is Turkish.
- There isn't a bus station in Liane's town.

WRITING

a post about your area

5A Read the travel guide. Match the headings (1–4) with the correct section (A–D).

- | | |
|------------------|------------------|
| 1 Places to stay | 3 Things to do |
| 2 Places to eat | 4 Places to shop |



Whitstable is a small town next to the sea in the south of England. It's about an hour by train from London and a great place to visit for the weekend!

- A** You can swim in the sea, walk on the beach and ride a bike to the old city of Canterbury about 30 minutes away.
- B** There are great places to eat in Whitstable. There are lovely cafés in the town centre and lots of fish restaurants near the sea. There are also very good Italian, Spanish and Thai restaurants.
- C** There are lots of small bookshops, clothes shops and gift shops. On Saturdays, there is a farmers' market in the town centre.
- D** There are lots of hotels and holiday apartments in Whitstable. Some of them are cheap and some of them are expensive.

B Choose the correct sentence (a–b). Pay attention to the commas.

- a** There are French British and Turkish cafés.

b There are French, British and Turkish cafés.
- a** There is a bus station, a train station, and an airport.

b There is a bus station, a train station and an airport.
- a** London is a great place to visit because it has everything.

b London is a great place to visit, because it has everything.

C Add commas to the sentences if necessary.

- Rome is great because there are lots of museums parks and shops.
- I like my town because there is lots to do.
- There isn't a cinema a sports centre or a swimming pool in my town.
- There is a supermarket and a shopping centre.

6A Write a travel guide about your town or city. First make notes about:

- | | |
|-----------------|------------------|
| • things to do | • places to shop |
| • places to eat | • places to stay |

B Write your travel guide. Use commas where necessary. Write 80–100 words.

Lesson 6C

HOW TO ... | ask where a place is

VOCABULARY | places in town (2); signs in buildings

PRONUNCIATION | weak forms with *to*, *of* and *the*

VOCABULARY

places in town (2)

1 Complete the text with the words in the box.

buildings bus stop car park
cash machine clock street

This is a photo of my town. This is the main ¹.....
You can see the shops and cafés. There are lots of
beautiful ²..... and a very old ³..... There's
a bank with a ⁴..... at one end of the street and
a ⁵..... at the other. There isn't a bus station but
there's a ⁶..... next to the car park.

signs in buildings

2 Select a word or phrase to fill the gaps.

1 A: Where's Room 201?

B: I don't know. Ask at the

a lift b information desk c car park

2 I don't have any money. Is there a near here?

a clock b cash machine c lift

3 A: What's the time?

B: Just a moment, there's a on my phone.

a bus stop b lift c clock

4 You can't go through that door – it's the exit, not the

a entrance b fire exit c stair

5 There isn't a lift, so we have to use the

a information desk b stairs c clock

6 A: Excuse me, is there a hospital near here?

B: Yes, it's ten minutes by bus. There's a
over there.

a building b school c bus stop

B 6.07 | Listen again and choose the correct alternative.

1 Jago is at the **train station / cinema**.

2 **Jago / Lily** is 30 minutes late.

3 The cinema is **10 / 15** minutes from the train station.

4 The bus stop is **next to / opposite** the train station entrance.

5 The bus stop is next to the **post office / library**.

6 The cinema is on the **first / second** floor of the shopping centre.

7 The cinema is **next to / opposite** the restaurant.

8 Lily is near the **information desk / lift**.

PRONUNCIATION

4A 6.08 | weak forms with *to*, *of* and *the* | Listen and underline the stressed words.

1 It's near the supermarket.

2 It's next to the sports centre.

3 It's to the right of the hospital.

4 I'm in front of the train station.

5 It's on the left of the library.

6 It's opposite the post office.

B 6.08 | Listen again and repeat the sentences. Pay attention to the weak forms of *the*, *of* and *to*.

SPEAKING

5A 6.09 | Complete the conversation with the words in the box. Then listen and check.

excuse far how know
near next opposite there

A: ¹..... me?

B: Yes?

A: Is there a library ²..... here?

B: Yes, ³..... is.

A: How ⁴..... is it?

B: About ten minutes from here.

A: ⁵..... do I get there?

B: Do you ⁶..... the museum?

A: Yes, I do.

B: It's ⁷..... the museum, ⁸..... to the post office.

A: Great, thank you.

B 6.10 | You are A in the conversation in Ex 5A. Listen and speak after the beep. Record the conversation if you can.

C Listen to your recording and compare it with the model in Ex 5A.

How to ...

ask where a place is

3A 6.07 | Listen to the conversation. Tick the places you hear.

- bus station
- bus stop
- cash machine
- cinema
- information desk
- library
- lift
- post office
- restaurant
- train station



Lesson 6D

GRAMMAR | *the*
 READING | 24 hours in ... Cairo

GRAMMAR

the

1 A Choose the correct alternative.

- Josué is from **a / the** big city in Brazil.
- A / The** Louvre is a museum in Paris.
- Do you have **a / the** sister?
- I usually have **a / the** sandwich for lunch.
- My birthday is on **a / the** 21st of September.
- Adem is **an / the** actor.
- What's **a / the** date today?
- My favourite room in my house is **a / the** kitchen.

B  The sentences below have a mistake. Choose the best option to correct the mistake.

- Kavita has two daughters and the son.
a an **b** a **c** any
- London is the capital of United Kingdom.
a an United Kingdom **b** the United Kingdom
c a United Kingdom
- I have some cat called Biggles.
a the **b** an **c** a
- Do you know an answer to question five?
a the **b** a **c** some

C Complete the blog with *a, an* or *the*.Where I live: Madrid   

Madrid is ¹..... capital of Spain. It is ²..... big city with lots of things to do. There are lots of museums – ³..... Prado Museum is very big and really interesting. There are beautiful streets and old buildings. ⁴..... Plaza Mayor is ⁵..... old square in the centre of Madrid – it's about 500 years old. There is also ⁶..... beautiful park with ⁷..... small lake called ⁸..... Retiro. You can go on ⁹..... boat on ¹⁰..... lake.

READING

2 A Read the travel guide. Match the photos (A–E) with the paragraphs (1–4). There is one extra photo.

B Read the guide again. Are the statements True (T) or False (F)?

- There are two big Pyramids at Giza.
- The Sphinx has a lion's head.
- You can see a famous mask at the Museum.
- You can see the Pyramids from Al Azhar Park.
- Khan Al Khalili is a very big supermarket.

24 hours in ... **Cairo**

Cairo is the capital of Egypt. It is a beautiful city and there are lots of things to see and do. Here are some ideas of where to go if you only have one day in this lovely place.

- Get up early and take a taxi to the Pyramids at Giza. There are three big Pyramids (the Great Pyramids) and lots of small ones. They are over 4,500 years old. You can also see the Sphinx, a famous monument of a lion with a man's head. You don't have time to go in the Pyramids, but you can take great photos.
- Your next stop is the Egyptian Museum. It's very big – there are over a hundred rooms! There are lots of really interesting things here. You can see old paintings, clothes, money and, of course, the famous mask of King Tutankhamun.
- In the afternoon, take the bus to Al Azhar Park. Here you can walk through the gardens or sit by the lake and relax. From the park, you can see old parts of the city and the Citadel, a very important building in Cairo.
- Your last stop is Khan Al Khalili market, a very big street market. There are hundreds of small shops here. You can buy lots of different things, but our favourites are lamps and rugs. Stop for a cup of coffee and a cake at one of the cafés if you're hungry.

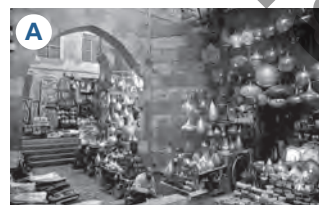

GRAMMAR

1 Match the subject pronouns (1-7) with the object pronouns (a-g).

- | | |
|--------|--------|
| 1 I | a us |
| 2 you | b it |
| 3 he | c him |
| 4 she | d me |
| 5 it | e them |
| 6 we | f her |
| 7 they | g you |

2 Choose the correct word to complete the sentences.

- Can I call tomorrow?
a me b you c your
- love my job!
a She b Me c I
- My parents have lunch with once a month.
a us b we c I
- My brother's name is Paco. Do you know?
a he b her c him
- I never drink coffee. I don't like
a it b him c her
- My grandparents live in China. I visit every summer.
a they b them c him

3 Write sentences about Leonora and Hiro. Use the information in the table and *can* or *can't*.

	Leonora	Hiro
swim five kilometres	✓	✗
play the guitar	✗	✓
drive a car	✓	✗
use chopsticks	✓	✓
play tennis	✗	✓
speak two languages	✓	✓

- Leonora can swim five kilometres. Hiro can't swim five kilometres.
-
-
-
-
-

4 Complete the sentences with the number word or ordinal word of the number in brackets.

- Jae has two cats. (2)
- Faye's birthday is on the of January. (11)
- We live on the floor. (10)
- It's the of December today. (1)
- There are train stations in my town. (4)
- This is my time in Mexico. (2)
- My birthday is on the of May. (3)
- Emre has jobs. (3)

5 Choose the correct option (a-c) to complete the sentences.

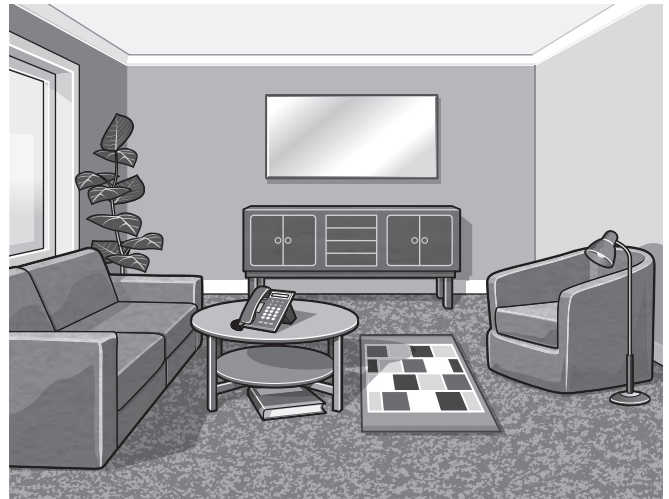

- The window is the sofa.
a between b behind c under
- The table is of the sofa.
a in front b behind c on
- The rug is the table and the armchair.
a opposite b between c under
- There's a book the table.
a in b on c under
- A phone is the table.
a next to b near c on
- There's a plant the window.
a behind b in c next to
- The armchair is the sofa.
a opposite b next to c between
- There's a lamp the armchair.
a near b on c in

6 Complete the description with the correct form of *there is / are (not)*. Use contractions where possible.

Lovely apartment, perfect for a weekend break.

- 1 two big bedrooms and a small bedroom. In the bathroom 2 a shower but 3 a bath.
4 a great kitchen with a fridge and a new cooker.
5 also a big table with eight chairs. In the living room, 6 a sofa, but 7 any armchairs.
There's a big balcony, but 8 a garden.

£150 per night

7 Complete the sentences with *a, an* or *the*.

- Great Wall of China is over 2,000 years old.
- David Hockney is famous British artist.
- It's two o'clock in afternoon.
- My wife is from USA.
- The museum is to left of the library.
- I'm from small city in Colombia.
- Wei's brother is actor.
- Your jacket is on sofa.

VOCABULARY

- 8A** Choose the correct alternative.
- I usually **get / take / call** coffee for my colleagues on Monday morning.
 - My manager is great. She always **thanks / says / helps** us for our work.
 - Chao often **sends / takes / helps** a two-hour lunch break.
 - I never **say / forget / call** my friends' birthdays.
 - My sister usually **helps / calls / thanks** me with my problems.
 - I **call / say / send** my grandfather every Sunday afternoon.
 - My neighbour is very friendly. He always **sends / says / thanks** 'hello' to me.
 - My friend Diya **calls / says / sends** me an email every week.

B Complete the phrases with the verbs in the box. There are two extra verbs.

dance drive play read remember paint
run sleep swim throw type use

- a picture
..... people
- tennis
..... football
- five kilometres
..... in the sea
- a computer
..... chopsticks
- salsa
..... the tango
- with your eyes closed
..... fast
- in the park
..... ten kilometres
- a book
..... a map
- people's names
..... your friend's birthday
- in a bed
..... on a bus

- 9** Complete the sentences with the opposite of the adjective in brackets.
- I get up very because I start work at six o'clock in the morning. (late)
 - The Grand Hotel is very It's £500 per night for a room! (cheap)
 - The supermarket isn't now – it's eleven o'clock at night. (closed)
 - I'm sorry, but you're The answer is 32. (right)

10 Write the furniture or parts of the house (1-10).

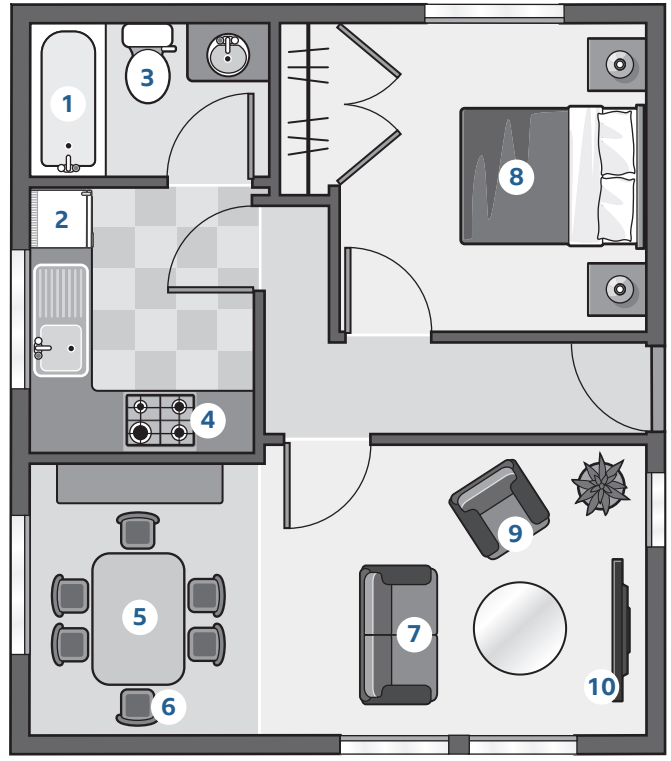

-
-
-
-
-
-
-
-
-
-

11 A Find eight places in a town in the word snake.

apollibraryhjschoolymuseummbchbanklaosupermarketcinemahospitaldbairport

B Complete the words in the conversation.

- A: Hello, are you new here?
B: Yes, this is my first day. I'm Daniel.
A: Welcome to Jones Design, Daniel! I'm Orla. So, this is the building. First, our office is on the third¹f..... There's a²l..... over there, next to the³i..... desk, or the⁴s..... are over there, on the left. There's a fire⁵e..... on every floor – look for the green signs. The café is on the second floor and there's a⁶c..... machine next to it.
B: Great, thank you. Is there a car⁷p..... area?
A: Yes. It's behind the office on 12th Street. There's also a bus⁸s..... opposite the entrance.